

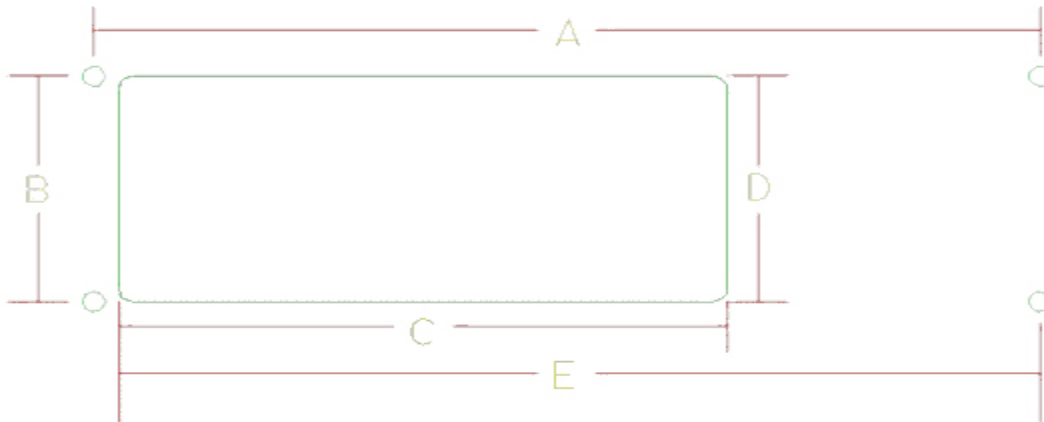

**JDF PERFORMANCE, INC.**  
**120 E. FM 544 SUITE 72 PMB 351**  
**MURPHY, TEXAS 75094**  
**214-687-6277**

**ORDER FORM FOR F6 INDUCTOR**

Please complete the form below to proceed with your order. On the next page you will find a diagram explaining exactly what each dimension refers to. All **F6 Inductors** are custom fitted to each supercharger, therefore making each one a custom piece. Because of this, we recommend you double-check **ALL** measurements before recording them below. Please call us if you have any questions regarding measuring the opening on your supercharger. When you have completed the form, please sign in the space provided and return it along with your deposit to **JDF Performance, Inc.**



**Bolt Pattern**

Length (**A**) and width (**B**) of top bolt pattern. Most superchargers will be 15.3125" (big pattern), or 13.2344" (small pattern) long and 4.4375" wide. Measure yours to be sure and complete below.

**A)** \_\_\_\_\_  
**B)** \_\_\_\_\_

**Supercharger Opening Dimensions**

This is your opening length (C) and width (D). Width on most will be 4.4375", and the length can vary drastically, with no real industry standard in this dimension. Measure yours and complete below.

C) \_\_\_\_\_  
D) \_\_\_\_\_

**Opening Location Relative to Bolt Pattern**

This is the opening location relative to the mounting bolt pattern. We measure from the rear boltholes to locate the opening. This dimension (E) varies with different supercharger manufacturers. Measure yours and complete below.

E) \_\_\_\_\_

**Supercharger Information**

Manufacturer \_\_\_\_\_  
Size \_\_\_\_\_  
Serial # \_\_\_\_\_

**Injector Application**

We offer the **F6 Inductor** in two styles, which we refer to as either "Drag Race" or "Pulling". The drag racing injectors are designed for applications where the throttle is instantly "snapped" open. The pulling injectors are designed to offer excellent throttle control as you open the throttle. We leave extra material in front of the blades to accomplish this, so it is imperative we know the application when manufacturing your injector.

Application: \_\_\_\_\_ (Drag Race or Pulling)

**DEPOSIT**

All **F6 Inductor** injectors are custom fitted to each customer's supercharger. Because of this, we require a deposit of \$1,000.00 at the time of order. All deposits need to be in the form of a certified check unless previous arrangements are made.

**Customer Information**

**Name:** \_\_\_\_\_

**Address:** \_\_\_\_\_

**Phone #'s:** \_\_\_\_\_

**Email:** \_\_\_\_\_

**Signature:** \_\_\_\_\_